







ERGOPLUS 555



CE EN60974-7



| CODE | ↔ | | ☐ |
|--------|-----|-------|---|
| MB7943 | 3 m | 10' |  |
| MB7944 | 4 m | 12' | |
| MB7945 | 5 m | 16.4' | |

| TECHNICAL DATA | | |
|---|---------------------------------|---------------|
|  | | |
|  | 1,45 kg | 3,20 lb |
| V PEAK | 113 | |
|  | 1,0 ÷ 2,4 mm | .040" ÷ 3/32" |
| X 100% | 550A CO ₂ - 500A Mix | |
|  | 2÷4 bar | |
|  | 1,6 l/min | |

TORCH HEAD REPAIR KIT MT0208



GAS HOLDER COOLING

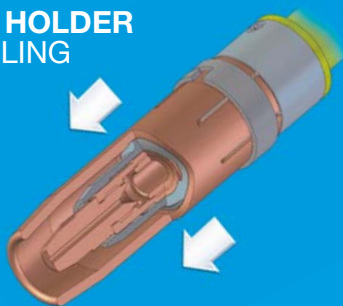

REFRIGERANT LIQUID UT1000158

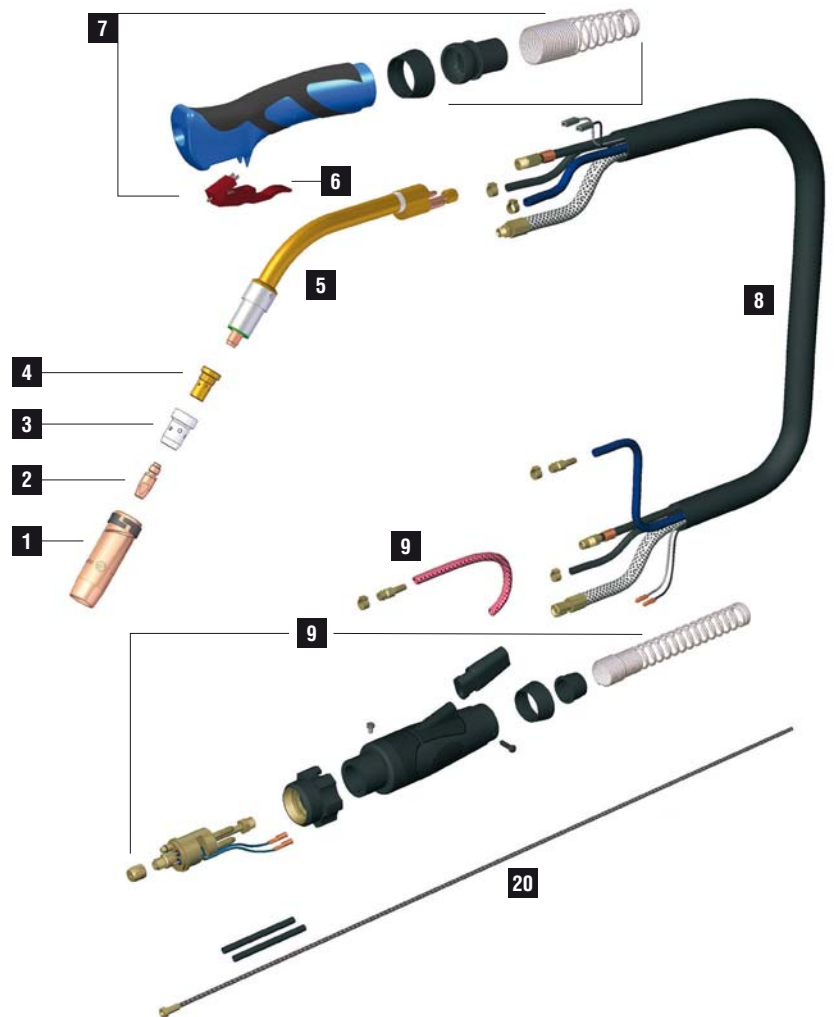

| | CODE | | | Ø | | | REF | |
|----|-----------|--|----------------------------|--------------|---------------|-------|------------|----|
| 1 | MC0268 | | 2,5 mm | 16 mm | 5/8" | 76 mm | 145.0085 | 10 |
| 1 | MC0276 | | light 2 mm | 16 mm | 5/8" | 76 mm | 145.0085 | 10 |
| 1 | MC0290 | | 2,5 mm | 14 mm | | 76 mm | 145.0132 | 10 |
| 1 | MC0291 | | 2,5 mm | 20 mm | | 76 mm | 145.0051 | 10 |
| 1 | MC0292 | | 2,5 mm | 15 mm | | 76 mm | - | 10 |
| 1 | MC0293 | | 2,5 mm | 20 mm | | 82 mm | 145.0179 | 10 |
| 1 | MC0340 | | heavy duty 3 mm | 16 mm | 5/8" | 76 mm | Heavy duty | 10 |
| 1 | MC0568 | | quick release 2,5 mm | 16 mm | 5/8" | 76 mm | - | 10 |
| 1 | MC0576 | | quick release - light 2 mm | 16 mm | 5/8" | 76 mm | - | 10 |
| 2 | MD0005-80 | | M8 - CuCrZr | 1,0 mm | .040" | 30 mm | 140.0316 | 20 |
| 2 | MD0005-82 | | M8 - CuCrZr | 1,2 mm | .045" | 30 mm | 140.0445 | 20 |
| 2 | MD0005-84 | | M8 - CuCrZr | 1,4 mm | .052" | 30 mm | - | 20 |
| 2 | MD0005-86 | | M8 - CuCrZr | 1,6 mm | 1/16" | 30 mm | 140.0590 | 20 |
| 3 | ME0400 | | M8 - brass | | | 25 mm | - | 10 |
| 3 | ME0402 | | M8 - copper | | | 25 mm | - | 10 |
| 4 | ME0074 | | plastic | | | 28 mm | - | 10 |
| 4 | ME0079 | | plastic | | | 29 mm | 300029 | 10 |
| 4 | ME0479 | | plastic High Tec | | | 28 mm | - | 10 |
| 4 | ME0579 | | ceramic | 16 mm | 5/8" | 28 mm | - | 10 |
| 20 | GM0530 | | uncoated steel liner | 1,2 ÷ 1,6 mm | .045" ÷ 1/16" | 3 m | 10' | 1 |
| 20 | GM0531 | | uncoated steel liner | 1,2 ÷ 1,6 mm | .045" ÷ 1/16" | 4 m | 12' | 1 |
| 20 | GM0532 | | uncoated steel liner | 1,2 ÷ 1,6 mm | .045" ÷ 1/16" | 5 m | 16.4' | 1 |

| | CODE | | | CODE | CABLE | | | CODE | ↔ | | CODE | ↔ | |
|---|--------|--|----|------|--------------------------|----------------------------------|--|------|--------|-------------|------|--------|-------------|
| 5 | FB1278 | | 10 | 8 | MN0012 | 3 m / 10' - 16 mm ² | | 8a | BX0156 | 3 m / 10' | 8d | QB0076 | 3 m / 10' |
| 5 | MG0095 | | 1 | 8 | MN0013 | 4 m / 12' - 16 mm ² | | 8a | BX0157 | 4 m / 12' | 8d | QB0077 | 4 m / 12' |
| 6 | BX0024 | | 10 | 8 | MN0014 | 5 m / 16.4' - 16 mm ² | | 8a | BX0158 | 5 m / 16.4' | 8d | QB0078 | 5 m / 16.4' |
| 7 | MT0239 | | 1 | 8a | Control leads | | | 8b | QB0072 | 3 m / 10' | 8e | QA0019 | 3 m / 10' |
| 9 | AR0052 | | 1 | 8b | Wire conduit | | | 8b | QB0073 | 4 m / 12' | 8e | QA0020 | 4 m / 12' |
| 9 | BW0020 | | | 8c | Gas hose | | | 8b | QB0074 | 5 m / 16.4' | 8e | QA0021 | 5 m / 16.4' |
| 9 | FA0026 | | 10 | 8d | Water inlet hose | | | 8c | QB0080 | 3 m / 10' | 8f | MQ0205 | 3 m / 10' |
| 9 | MT0101 | | 1 | 8e | Water outlet power cable | | | 8c | QB0081 | 4 m / 12' | 8f | MQ0206 | 4 m / 12' |
| | | | | 8f | Cover | | | 8c | QB0082 | 5 m / 16.4' | 8f | MQ0207 | 5 m / 16.4' |

STANDARD

FOR ALL CONSUMABLES SEE PAGE 294