

ERGOTIG SUPER 18



CE EN60974-7



CODE	↔	⚡	⚡
------	---	---	---

S11410-00	4 m	12.5'	sintig	
S11810-00	8 m	25'	sintig	TSK 50-1/4G

TECHNICAL DATA	
----------------	--

	0,90 kg 1.98 lb
V PEAK	113
	Argon
	0,5 ÷ 4,0 mm .020" ÷ 5/32"
X 100%	400A DC - 300A AC
	4 bar
	1.5 l/min



CONSUMABLES KIT

TT0103	1,6 mm	1/16"
TT0104	2,4 mm	3/32"
TT0105	3,2 mm	1/8"

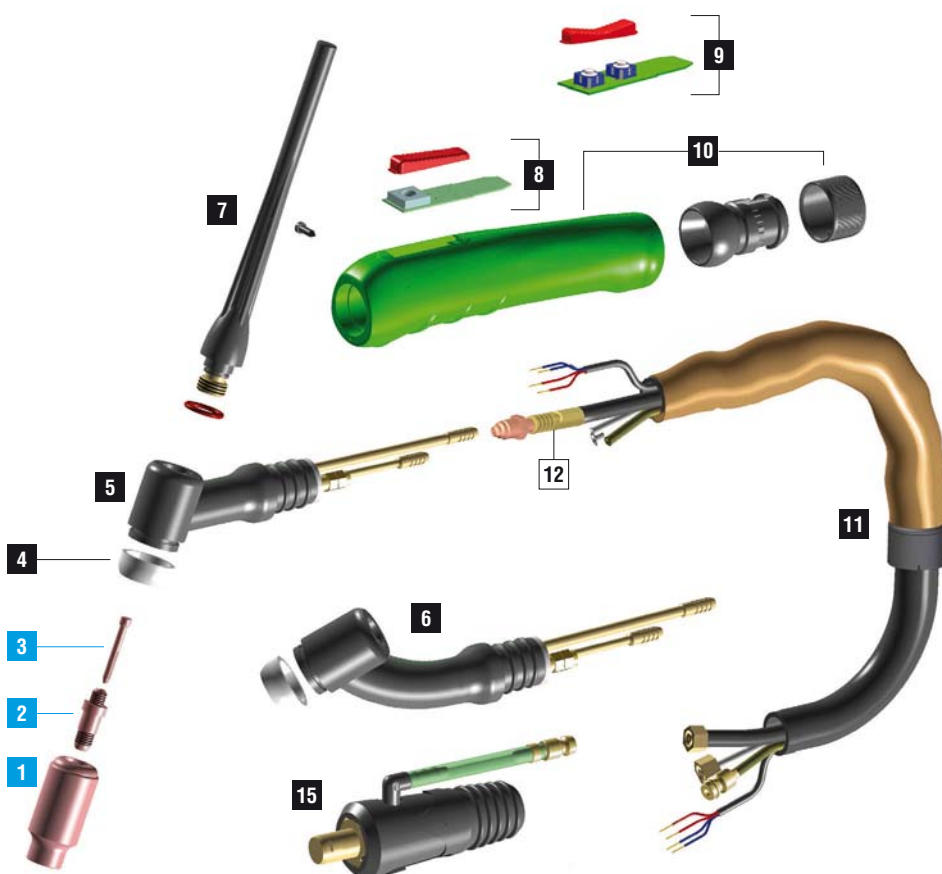

CONSUMABLES NOT INCLUDED

	CODE		Gr	Ø		↔	REF	
1	TC0002		4	6,4 mm	1/4"	47 mm	10N50	10
1	TC0003		5	8 mm	5/16"	47 mm	10N49	10
1	TC0004		6	9,8 mm	3/8"	47 mm	10N48	10
1	TC0005		7	11,2 mm	7/16"	47 mm	10N47	10
1	TC0006		8	12,7 mm	1/2"	47 mm	10N46	10
1	TC0007		10	15,7 mm	5/8"	47 mm	10N45	10
1	TC0008		12	19 mm	3/4"	30 mm	10N44	10
1	TC0091		5	8 mm	5/16"	76 mm	10N49L	10
1	TC0092		6	9,5 mm	3/8"	76 mm	10N48L	10
1	TC0093		7	11 mm		76 mm	10N47L	10
2	TE0001-05			0,5 mm	.020"	47 mm	10N29	10
2	TE0001-10			1,0 mm	.040"	47 mm	10N30	10
2	TE0001-16			1,6 mm	1/16"	47 mm	10N31	10
2	TE0001-20			2,0 mm	5/64"	47 mm	-	10
2	TE0001-24			2,4 mm	3/32"	47 mm	10N32	10
2	TE0001-32			3,2 mm	1/8"	47 mm	10N28	10
2	TE0001-40			4,0 mm	5/32"	47 mm	406488	10
2	TE0001-48			4,8 mm	3/16"	47 mm	30126	10
3	TD0001-05			0,5 mm	.020"	50 mm	10N21	10
3	TD0001-10			1,0 mm	.040"	50 mm	10N22	10
3	TD0001-16			1,0 mm	.040"	50 mm	10N23	10
3	TD0001-20			1,6 mm	1/16"	50 mm	-	10
3	TD0001-24			2,4 mm	3/32"	50 mm	10N24	10
3	TD0001-32			3,2 mm	1/8"	50 mm	10N25	10
3	TD0001-40			4,0 mm	5/32"	50 mm	54N20	10
3	TD0001-48			4,8 mm	3/16"	50 mm	30028	10
7	BW0056					58 mm	-	10
7	BW0066					117 mm	57Y02	10
7	BW0067					22,5 mm	57Y04	10
7	EA0130							10

	CODE			
4	TQ0008		insulator	10
5	TG0913		tig torch head 18HC	1
6	TG0914		tig torch head 18HC Flex	1
8	TT0181		kit Ergotig single	1
9	TT0182		kit Ergotig dual	1
10	BW0311		cable support	
10	EA0329		screw	
10	TP0090		tig handle	1

	CODE			
15	CX0080		tig plug 50 – gas quick conn.	

	CODE	CABLE	
11	TH0228	4 m / 12.5'	1
11	TH0229	8 m / 25'	1

	CODE		
12	TH0336	4 m / 12.5'	
12	TH0337	8 m / 25'	

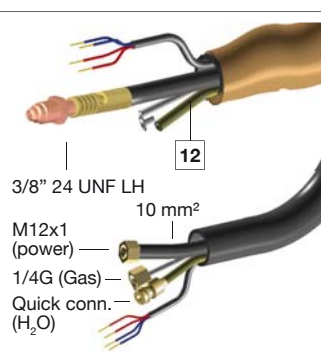

FOR ALL CONSUMABLES SEE PAGE 469