

ERGOTIG SUPER 20







CE EN60974-7

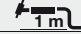

CODE	↔	↔	↔
------	---	---	---

S61410-00	4 m	12.5'	sintig	 TSK 50-1/4G
S61810-00	8 m	25'	sintig	

TECHNICAL DATA	
----------------	--

	
	0,85 kg 1.87 lb
V PEAK	113
	Argon
	0,5 ÷ 3,2 mm .020" ÷ 1/8"
X 100%	320A DC - 250A AC
	4 bar
	1.5 l/min

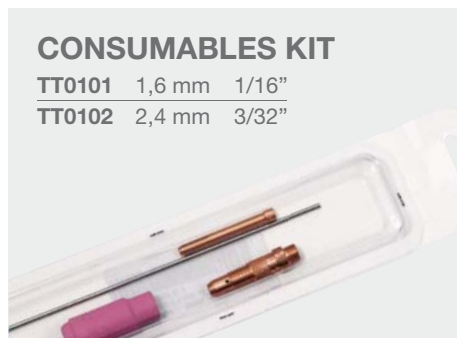

CONSUMABLES KIT

- TT0101 1,6 mm 1/16"
- TT0102 2,4 mm 3/32"

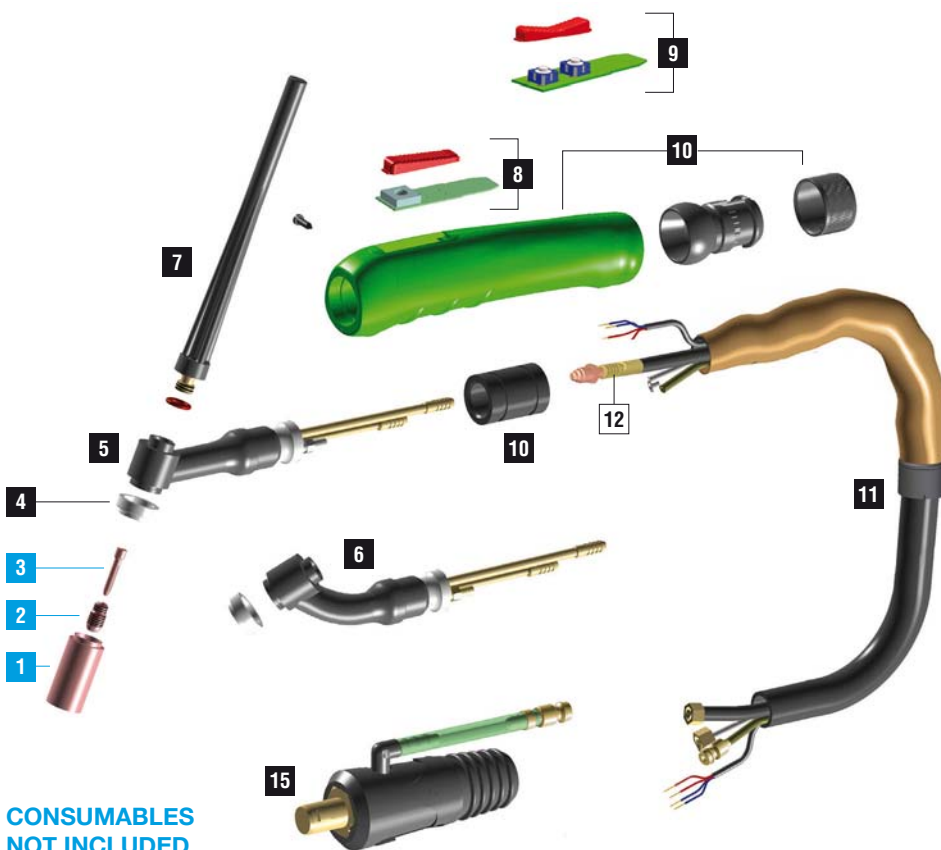

CONSUMABLES NOT INCLUDED

	CODE		Gr	Ø		↔	REF	
1	TC0012		4	6,4 mm	1/4"	30 mm	13N08	10
1	TC0013		5	8 mm	5/16"	30 mm	13N09	10
1	TC0014		6	9,8 mm	3/8"	30 mm	13N10	10
1	TC0015		7	11,2 mm	7/16"	30 mm	13N11	10
1	TC0016		8	12,7 mm	1/2"	30 mm	13N12	10
1	TC0017		10	15,7 mm	5/8"	30 mm	13N13	10
1	TC0096		4	6,5 mm	1/4"	48 mm	796F71	10
1	TC0097		5	8 mm	5/16"	48 mm	796F72	10
1	TC0098		6	9,5 mm	3/8"	48 mm	796F73	10
1	TC0101		4	6,5 mm	1/4"	63 mm	796F75	10
1	TC0102		5	8 mm	5/16"	63 mm	796F76	10
1	TC0103		4	6,5 mm	1/4"	89 mm	796F79	10
2	TE0003-05			0,5 mm	.020"	21 mm	13N25	10
2	TE0003-10			1,0 mm	.040"	21 mm	13N26	10
2	TE0003-16			1,6 mm	1/16"	21 mm	13N27	10
2	TE0003-20			2,0 mm	5/64"	21 mm	-	10
2	TE0003-24			2,4 mm	3/32"	21 mm	13N28	10
2	TE0003-32			3,2 mm	1/8"	21 mm	13N29	10
3	TD0003-05			0,5 mm	.020"	25 mm	13N20	10
3	TD0003-10			1,0 mm	.040"	25 mm	13N21	10
3	TD0003-16			1,6 mm	1/16"	25 mm	13N22	10
3	TD0003-20			2,0 mm	5/64"	25 mm	-	10
3	TD0003-24			2,4 mm	3/32"	25 mm	13N23	10
3	TD0003-32			3,2 mm	1/8"	25 mm	13N24	10

7	BW0063					147,5 mm	41V24	10
7	BW0064					53 mm	41V35	10
7	BW0065					17,5 mm	41V33	10
7	EA0129							10

CODE			
------	--	--	--

4	TQ0001		insulator	10
5	TG0912		tig torch head	1
6	TG0911		tig torch head Flex	1
8	TT0181		kit Ergotig single	1
9	TT0182		kit Ergotig dual	1
10	BW0304		reduction	1
10	BW0310		cable support	
10	EA0329		screw	

CODE			
------	--	--	--

10	TP0090		tig handle	1
15	CX0080		tig plug 50 – gas quick conn.	

CODE	CABLE	
11	TH0228	4 m / 12.5' 1
11	TH0229	8 m / 25' 1

CODE	↔
12	TH0336 4 m / 12.5'
12	TH0337 8 m / 25'

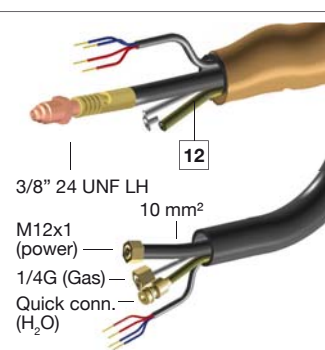

FOR ALL CONSUMABLES SEE PAGE 469